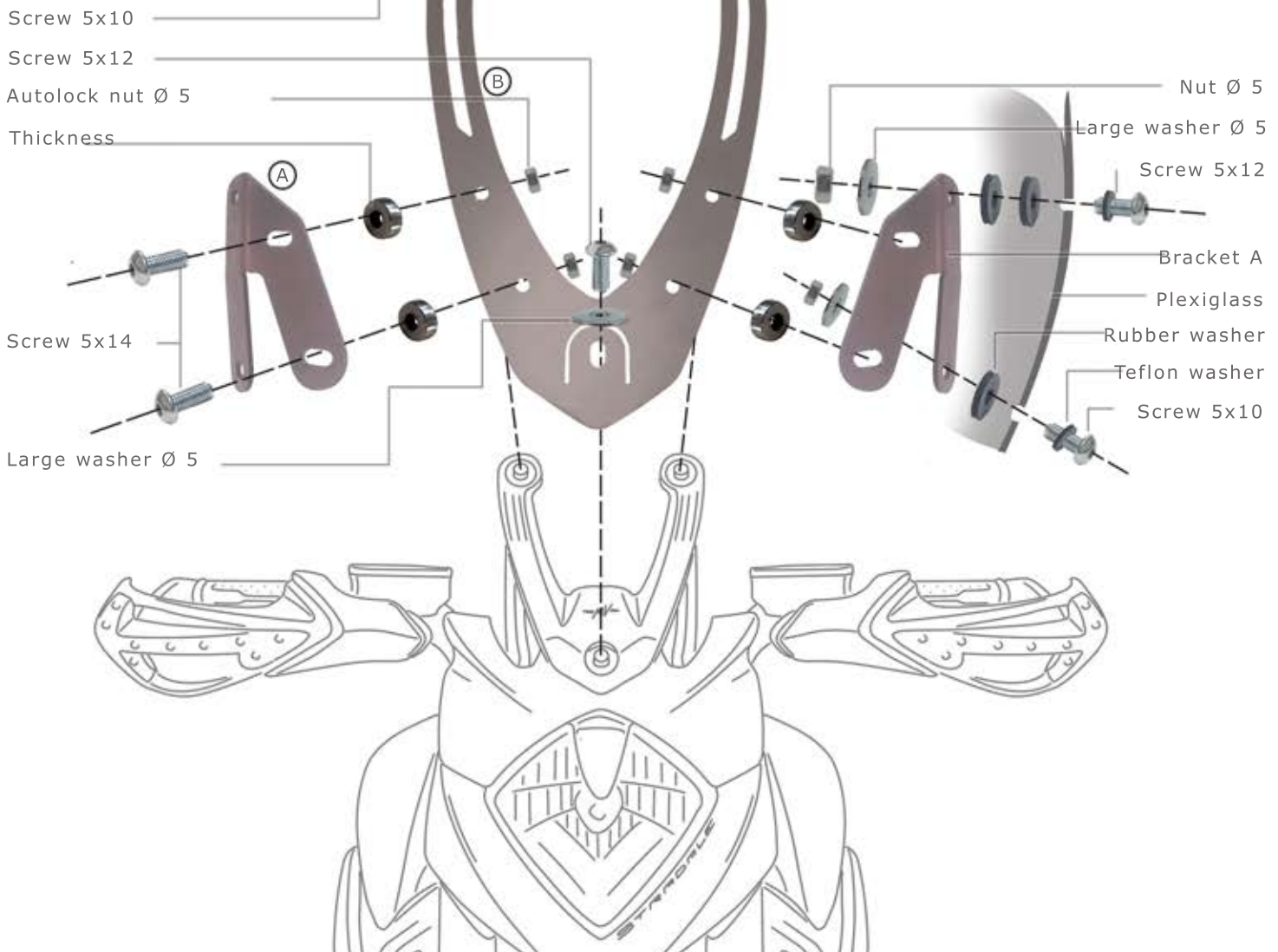

MOUNTING PROCEDURE**KIT WINDSHIELD
MV AGUSTA STRADALE 800****MS8300**WWW.BARRACUDAMOTO.COM**FIXING PROCEDURE:**

- REMOVE THE ORIGINAL SCREWS AND RELATIVE WINDSHIELD;
- APPROACH THE SPECIFIC BRACKETS (A-B) AND RELATIVES THREAD THICKNESS LIKE SCHEME AND THAN LOCK THE BRACKET (B) ON THE MOTORBIKE;
- FIND THE RIGHT POSITION OF THE WINDSHIELD ON THE BRACKET ALREADY FIXED E LOCK ALL THE SCREWS;

KIT

- X1. PLEXIGLASS
- X2. BRACKET (A)
- X1. STIRRUP (B)
- X4. THICKNESS (H)
- X8. NUT \varnothing 5 AUTOLOCK
- X4. SCREW "ROUND HEAD" 5X14
- X3. SCREW "ROUND HEAD" 5X12
- X4. SCREW "ROUND HEAD" 5X10
- X5. WASHER \varnothing 5 LARGE
- X4. TEFLON WASHER \varnothing 5
- X6. RUBBER WASHER

FIXING BRACKET**FIXING WINDSHIELD**

NOTE: DON'T LOCK TOO MUCH TO AVOID POSSIBLE BROKEN.